



SCALE MODEL

M a k i n g C o m p a n y

About Company

A dream was realized in November 2016 when Maadhu Creatives came into existence. We are a young and dynamic organization with ambition and a vision to be global leaders in scale model making. Our ambition is greatly supported by our team of experienced and enthusiastic craftsmen, who are veterans in their work.

The company was established with a vision to provide unrivaled creative model-making services and solutions. Over the years we have developed ourselves into the most trusted model-making solution provider across the world. We not only design and build the models that our client requires but we also help them envision the model of their dreams. We brainstorm and consult on the best creative way forward on developing a great model.

Our belief is in our identity 'Our Logo'. Our logo depicts a Ninja Warrior weapon popularly known as the 'Ninja Star' or 'Shuriken'. The ninja warriors are known for their commitment, accuracy, swiftness and their weapons are developed for maximum impact. Our company's philosophy also imbibes the same characteristics in its creative deliverables. We are the warriors of creativity. The texture of the logo and the color used also hold a special significance. The texture signifies our weapon 'Paper' and color signifies the peace in creativity.

The dynamism of a young company like ours is also evident in the fact that we are a strong supporter of innovation and the use of technology in our work. One of the quotes by Steve Jobs that we strongly believe in and promote is 'Innovation distinguishes between a Leader and a Follower.'

The use of technology makes our lives easy, enhances the quality of our deliverables, and enables meeting timelines accurately. This allows us time to focus on more creative solutions. We have been in step with the latest innovation and have provided the first-mover advantage by adopting the latest technologies. The latest machines and equipment for laser and 3D printing are installed in our workshop with a well-trained team of experts to operate them.

Our models have catered to the needs of all age groups of audience and have been relevant in fulfilling a wide range of purposes. With the experience gained through the years, we design and deliver models globally. A firm supporter of the 'Make in India' and 'Vocal for Local' initiatives started by the Government of India, we believe in utilizing the talent within the country and make it available across geographies.

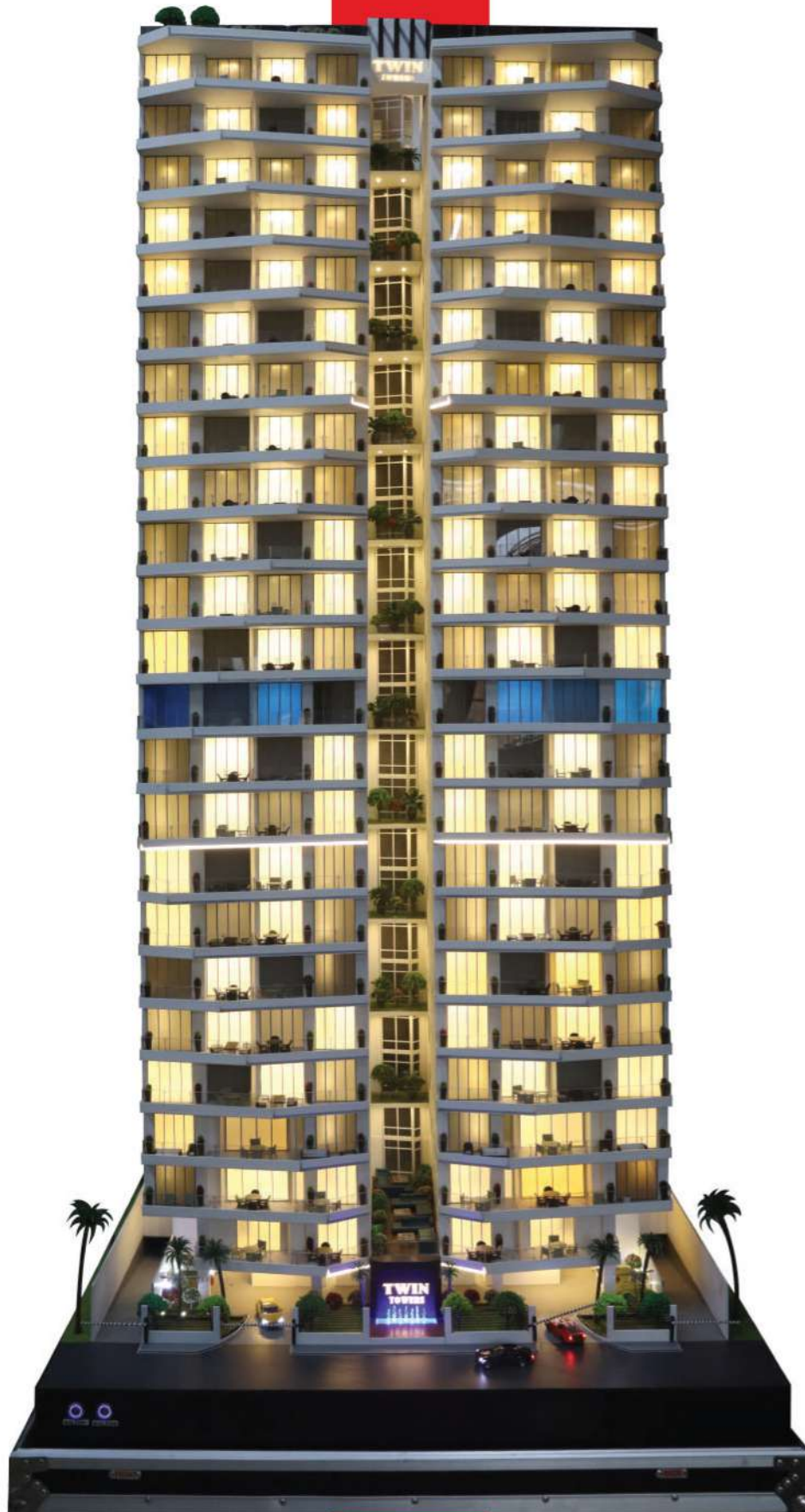



Vision & Mission



To become the global leaders in providing best in class scale model-making solutions at affordable cost and to become synonyms for model-making solution providers like 'Google is for Search'.



To be numero uno in providing top-notch model-making solutions globally.



Service



Exterior
Architectural Model

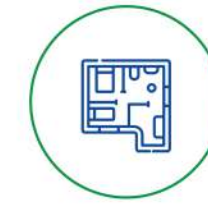

Interior
Architectural Model



Engineering
Scale Model



Industrial Scale
Model



Working
Scale Model



Product Prototyping
Scale Model



Marine Scale
Model



Layout Scale
Model



Piping Scale
Model



Plant Scale
Model



Exhibition Scale
Model



Study Scale
Model



Client



Capacity



1

We have our workshop located in Mumbai where the customer can visit.

2

Highly Skilled Staff

- Skilled Craftsmen
- Drawing Management
- Project Management

3

State of The Art

- CAD
- Laser Machines
- Advance Model Equipment
- 3D Printers



PORTFOLIO



Architectural Model Making

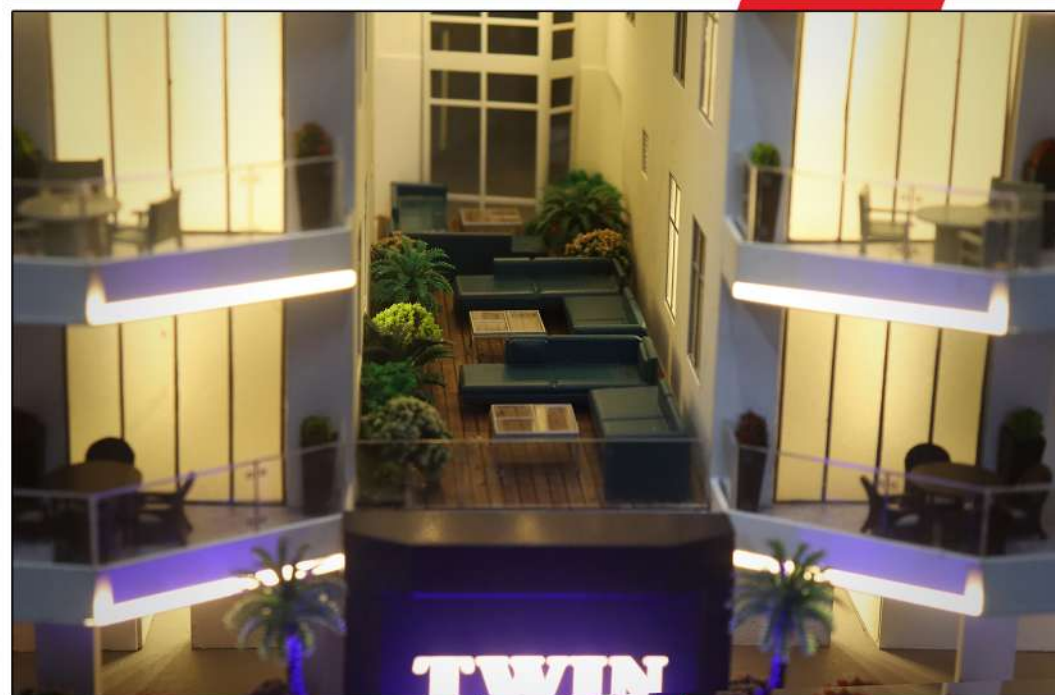
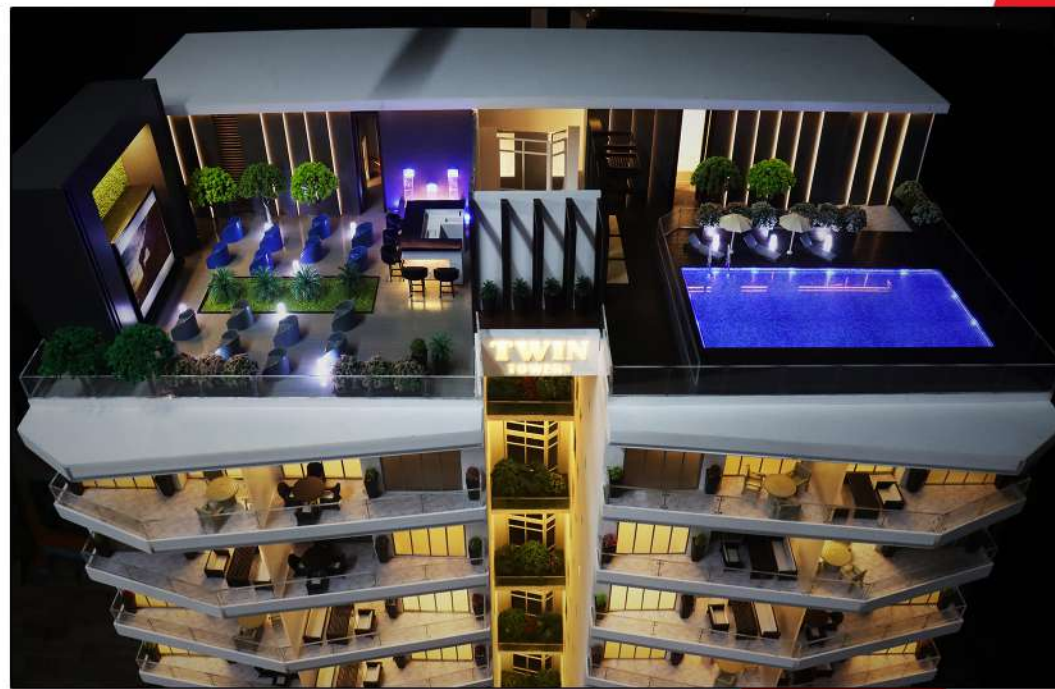

Exterior Model Making

PORTFOLIO



Architectural Model Making

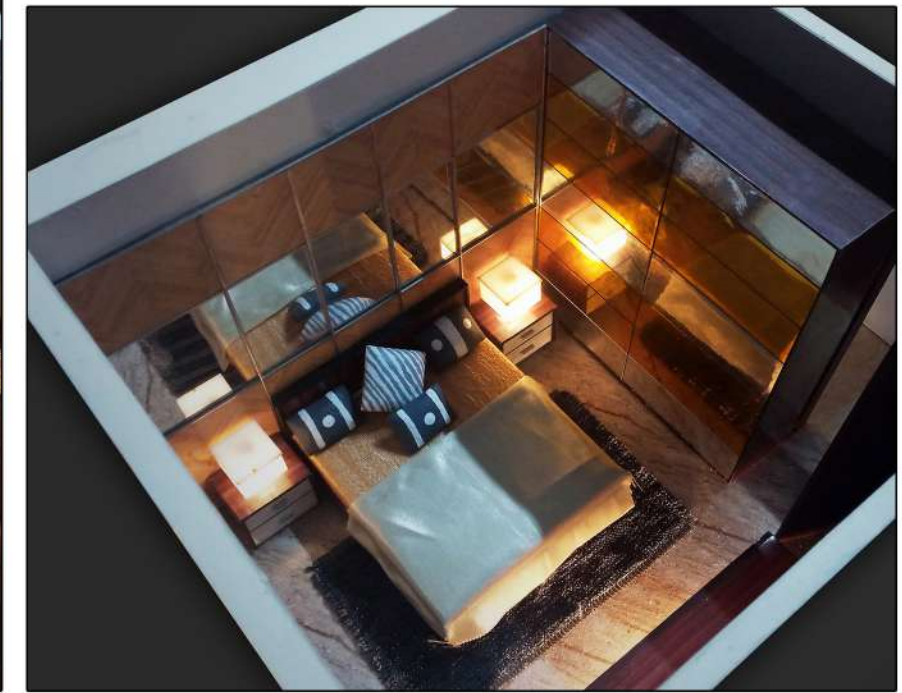
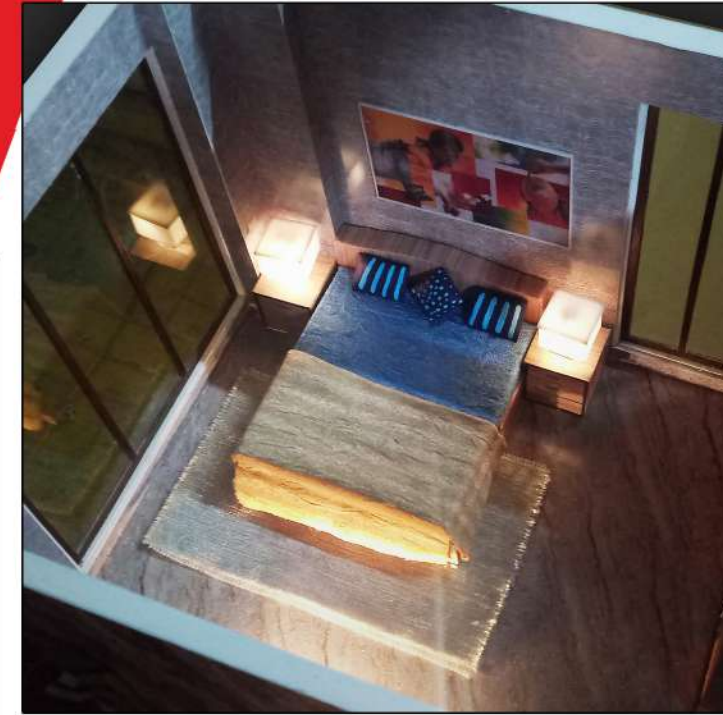

Interior Model Making



PORTFOLIO



Master Plan Model Maker



PORTFOLIO



Industrial Model Making

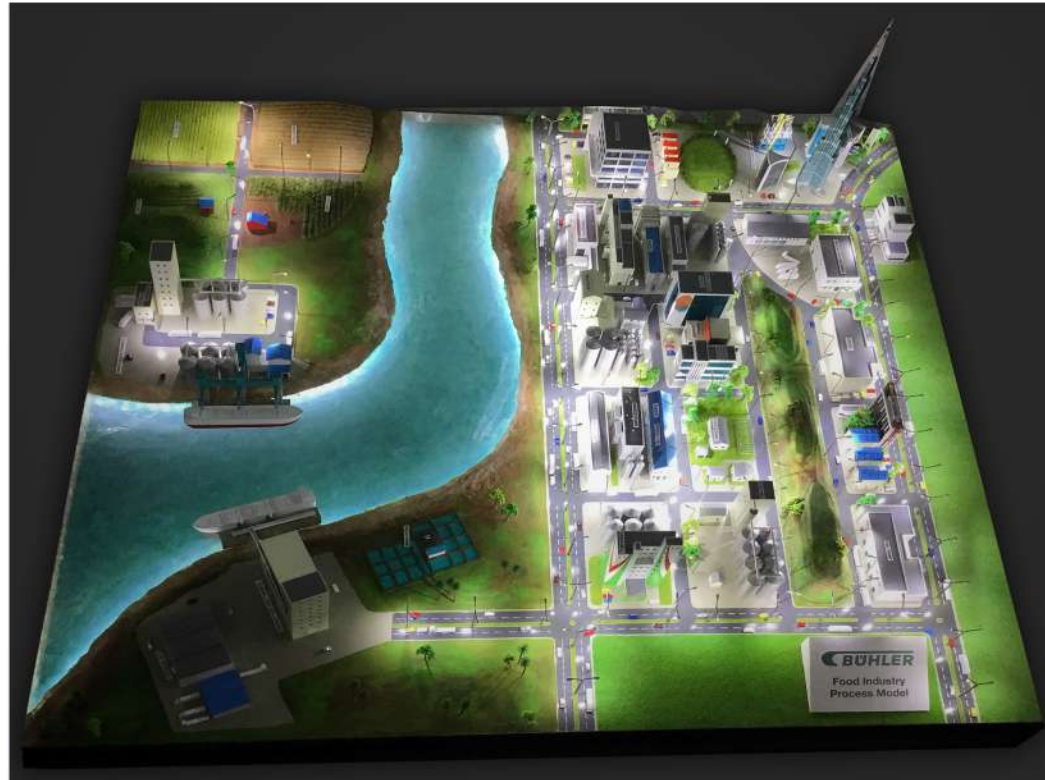

PORTFOLIO



Block Model Maker

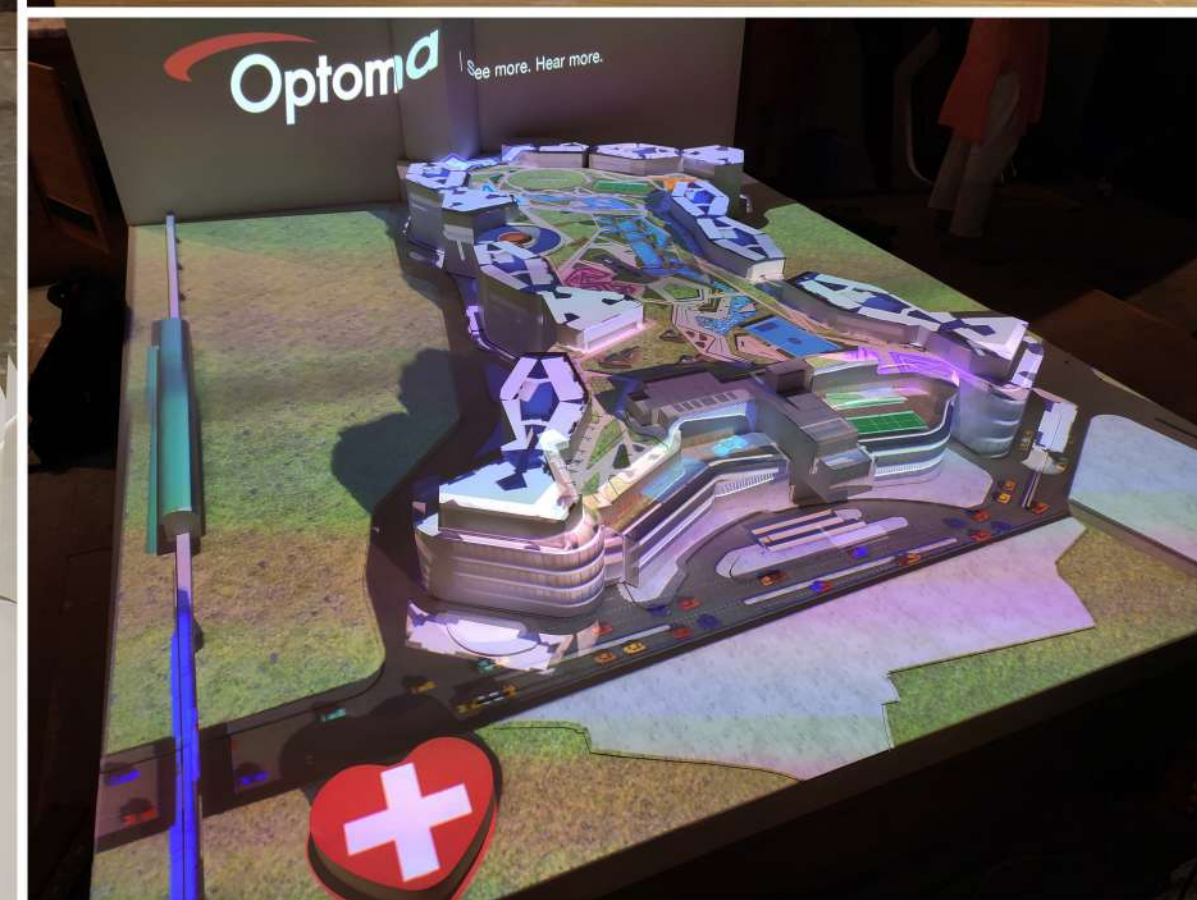
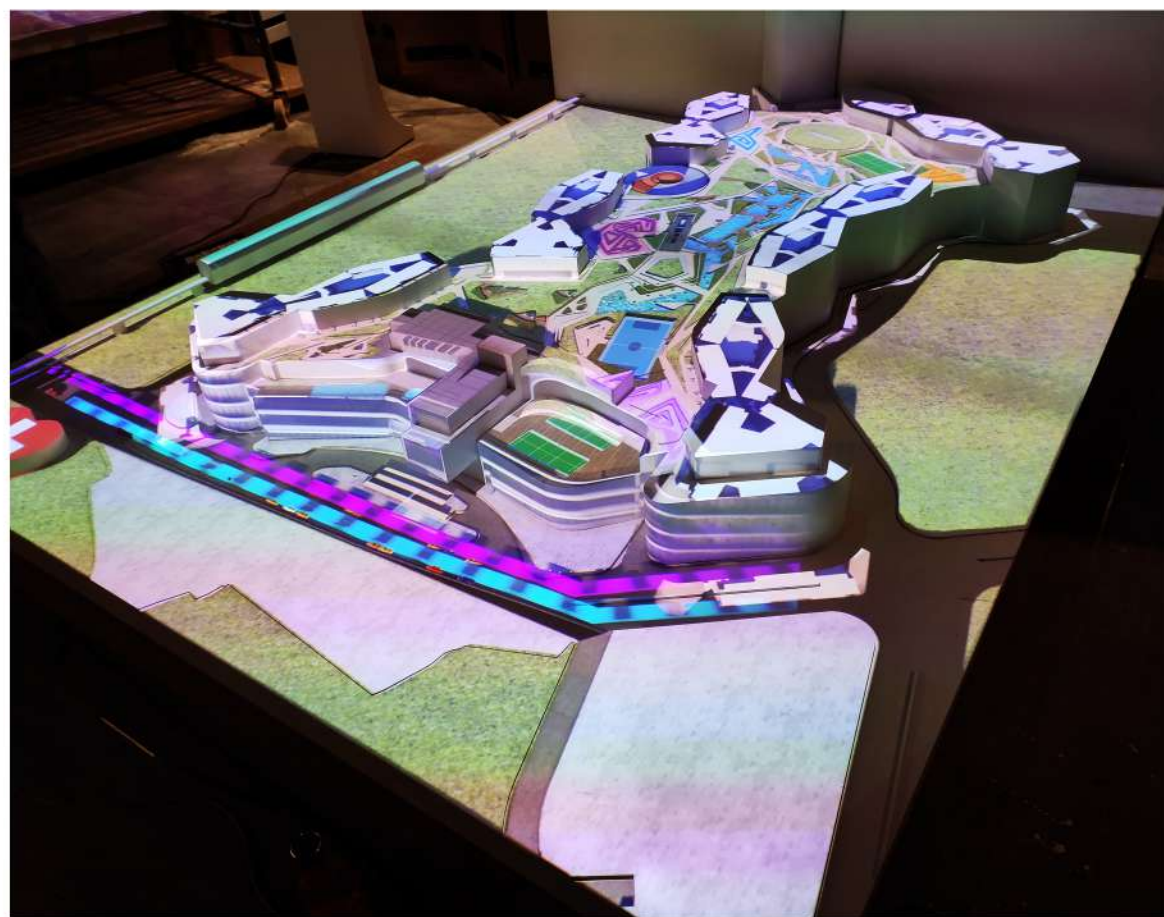
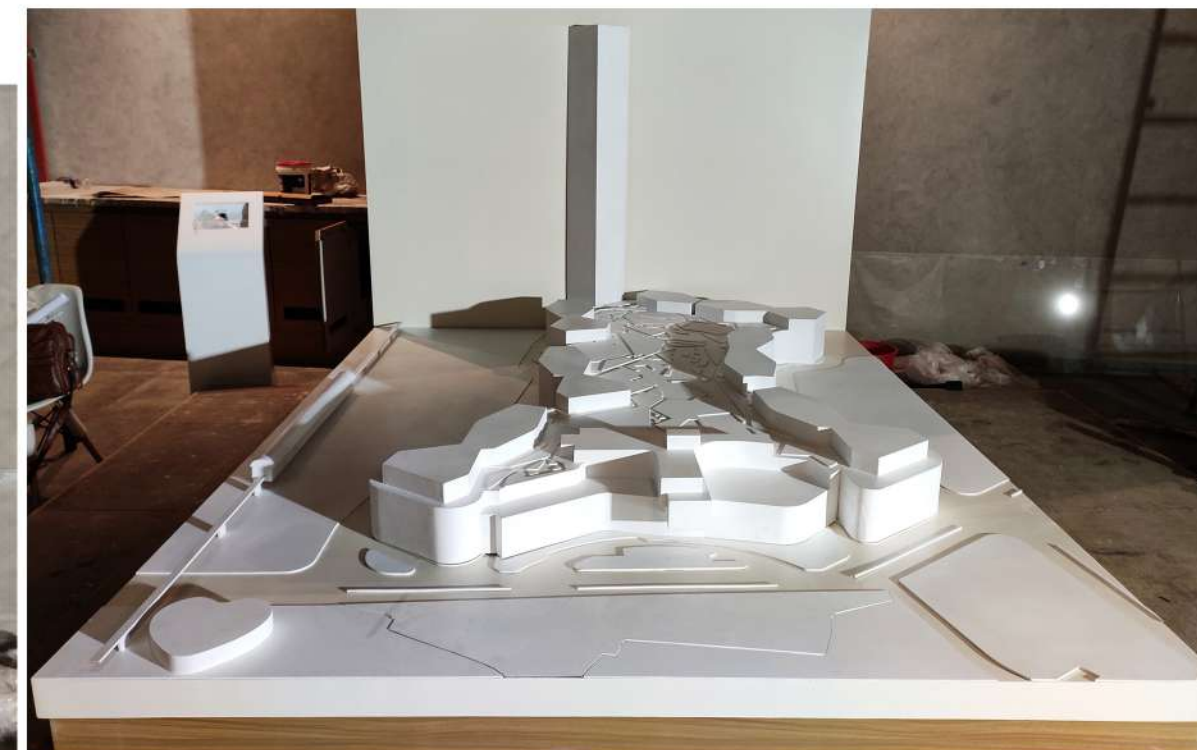

PORTFOLIO



Engineering Model Maker

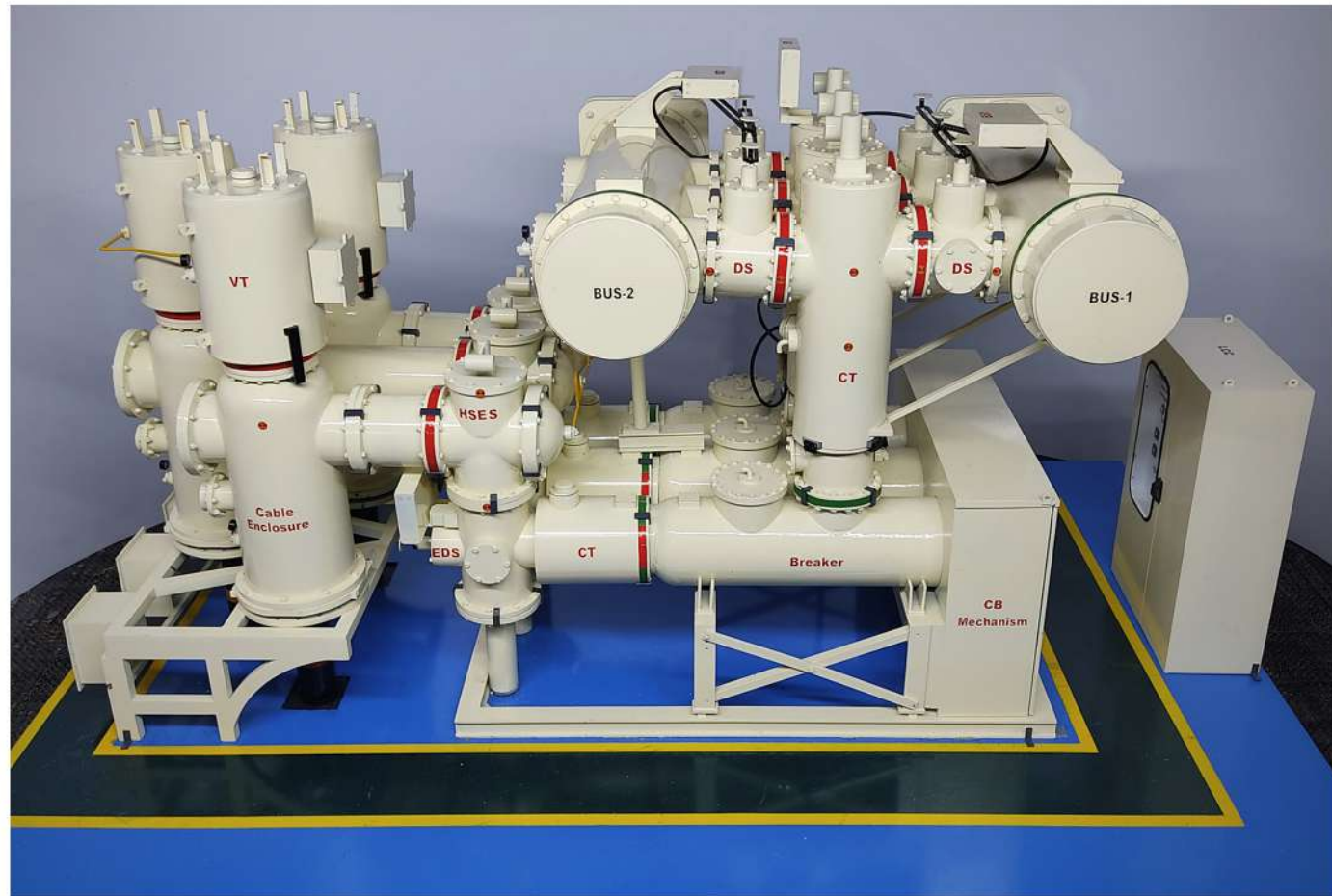

PORTFOLIO



Ship & Maritime Model Maker



PORTFOLIO



Theme Parks Model



Material

Advance Material

Acrylic Sheets	Resin Based Water Simulation
H.I.P Sheets	Fiber Optic Lighting and LED
Foam Sheets	Realistic Landscape Components
P.V.C Sheets	Wood
A.B.S Rod	P.V.C Pipes
Metal Rod	A.B.S Rod

In-house Material

Hand made Trees	Human Figures	Cars
Shrubs	Street Light	Furniture





Shipping & Packing

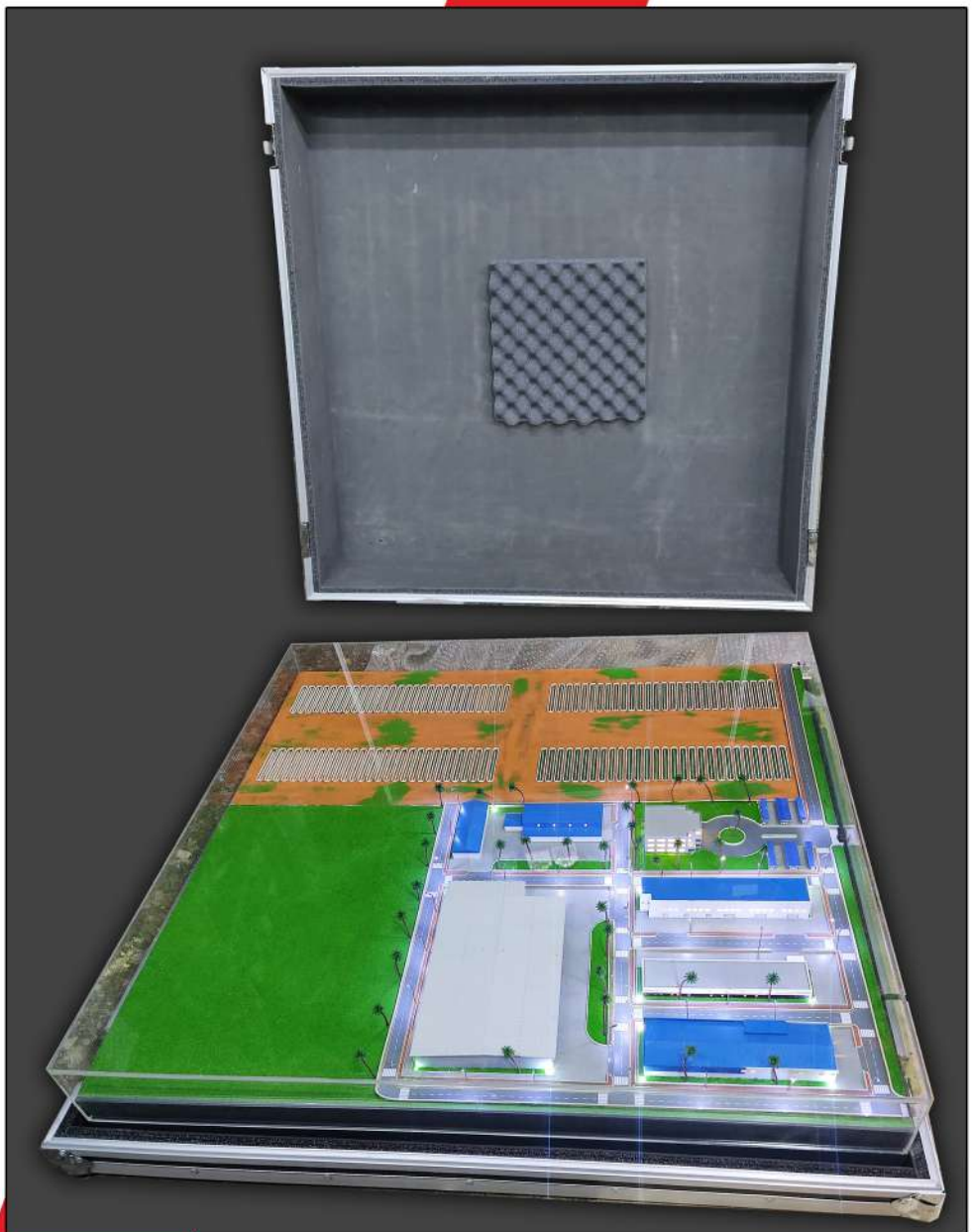



Do you have any questions?



India Office

2 , Nagarwal Compound, Carter Road No.1,
Borivali East.Mumbai-400066. India
info@maadhucreatives.com | +1 902 943 2910 (Canada)



Canada Office

5770 Spring Garden Road, Halifax, NS, Canada
karna@maadhucreatives.com | +1 902 943 2910 (Canada)

